

iSchoolRide

iSchoolRide Pickup Line App Android User Guide



iSchoolRide PickupLine App

Android User Guide

Welcome to the iSchoolRide PickupLine app! This guide will help you get started quickly and ensure a smooth experience when using the app to pick up your student(s). For additional help, refer to the graphical user instructions included in this document for a detailed, step-by-step visual guide

1. Download the app:

If you haven't already downloaded the app, you can get the **iSchoolRide PickupLine** app from [Google Play](#), or search for **iSchoolRide PickupLine** directly in the app store.

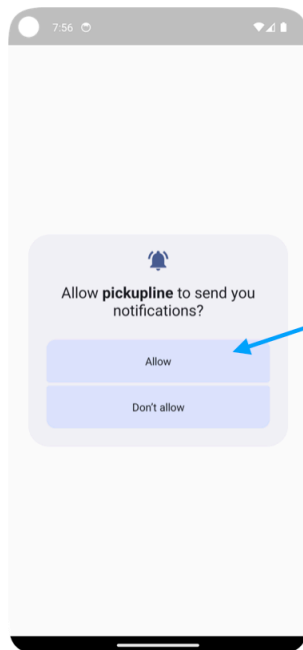

Make sure to allow iSchoolRide to send you notifications.

Make sure to **allow iSchoolRide to send you notifications** so that you can be notified when your student(s) are released and when your family members are picking up your student(s) on your behalf.

2. Create an account and add/edit student(s):

You can follow the steps below or refer to the graphical user instructions included in this document. A detailed, step-by-step visual guide is available for your convenience.

Step 1:

If you're a new user, tap on **'Create New Account'** to begin. You will need a valid School Code provided by your School Admin.

Step 2:

Enter the **School Code** and complete all required fields with your personal information. Once done, tap **'REGISTER'** to proceed.

A School Code is provided to you by School Admin. Please contact your School Admin to get this code.

Step 3:

Update the sample student information by tapping **'Manage Students'** on the home screen. This will take you to the 'Manage Students' screen.

Step 4:

Add your student by entering their name, grade, and ensure the **'Included in Pickup'** option is checked.

Step 5:

Tap the **'Back'** button to return to the Home screen.

Step 6:

When you're ready to pick up your student(s), tap **'Go Online'** to notify teachers/admins that you have arrived in the Pickup Zone. Make sure to:

- Select **'Allow'** on the location access prompt.
- Choose **'Precise'** location access.
- Select **'While using the app'** for location access.

Step 7:

You're all set! You are ready to use the iSchoolRide PickupLine app to pick up your student(s).

ISCHOOLRIDE

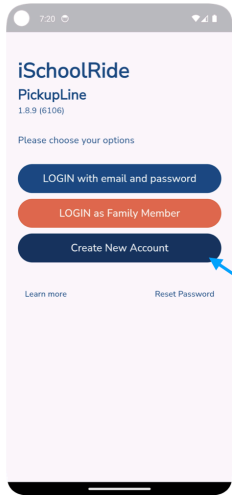

Make sure to enter a valid School Code and fill out all the required information about yourself. Tap on 'REGISTER' to continue

For new user, tap on 'Create New Account' to register new account

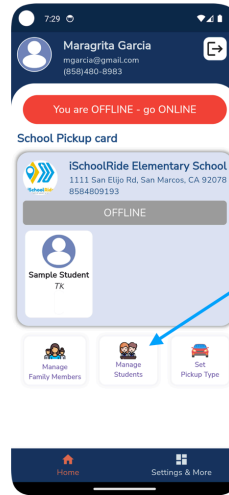
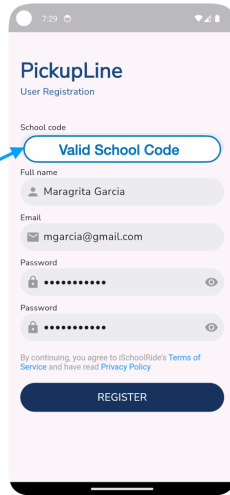

Change the Sample Student to your student by tapping on 'Manage Students' button

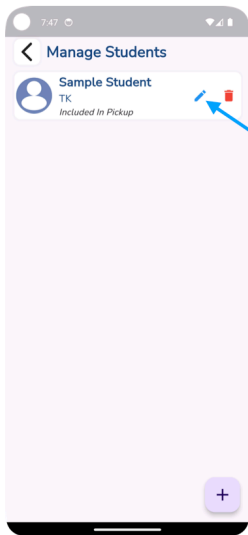

Tap on the 'Edit' icon to change Sample Student to you student

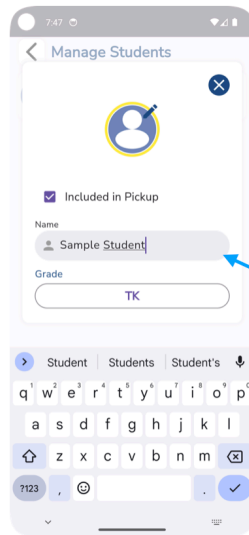

Enter your student name and select grade. Make sure to check 'Included in Pickup' if you are pickup this student

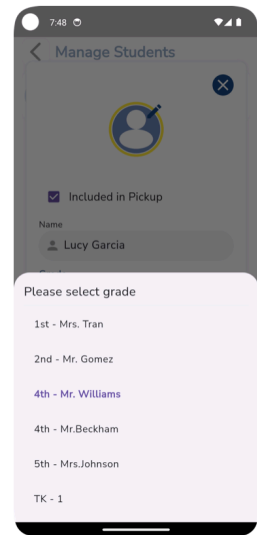

ISCHOOLRIDE

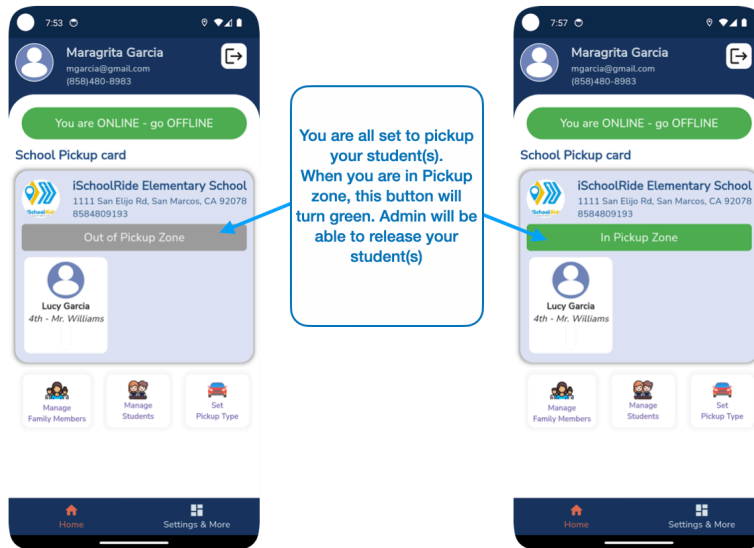
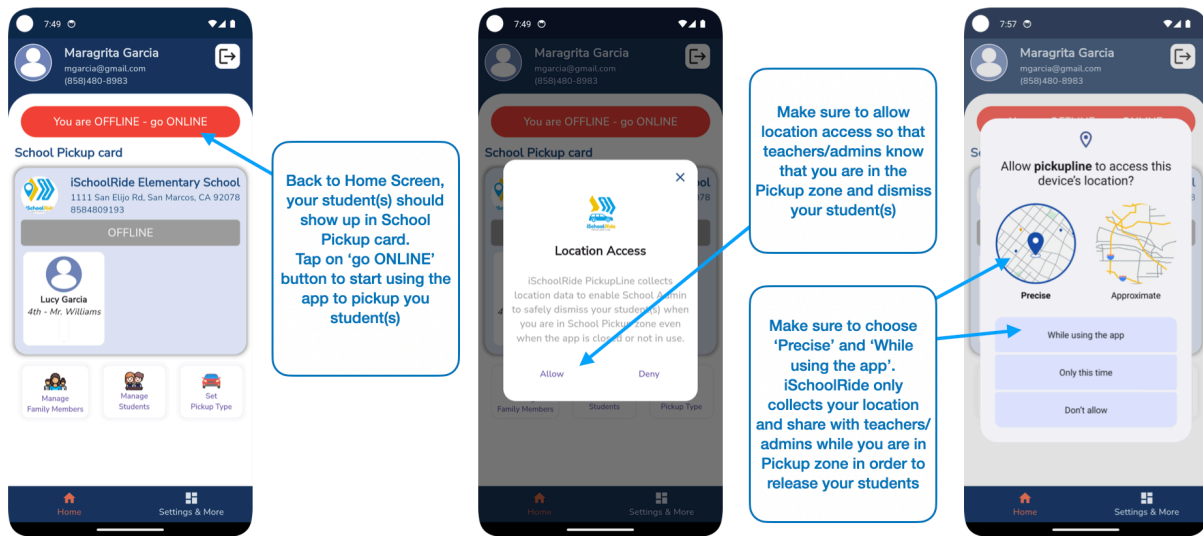

Once you enter the school's Pickup Zone, teachers/admins will be notified to release your student(s) for dismissal.

Once you pickup your student(s) and leave school's Pickup zone, you can now close the app.

3. Add/Edit family members:

The Family Members feature allows you to add up to 6 individuals who can pick up your student(s) on your behalf. You can add, edit, or remove family members using the iSchoolRide PickupLine app. A detailed, step-by-step visual guide is also available in this document for your convenience.

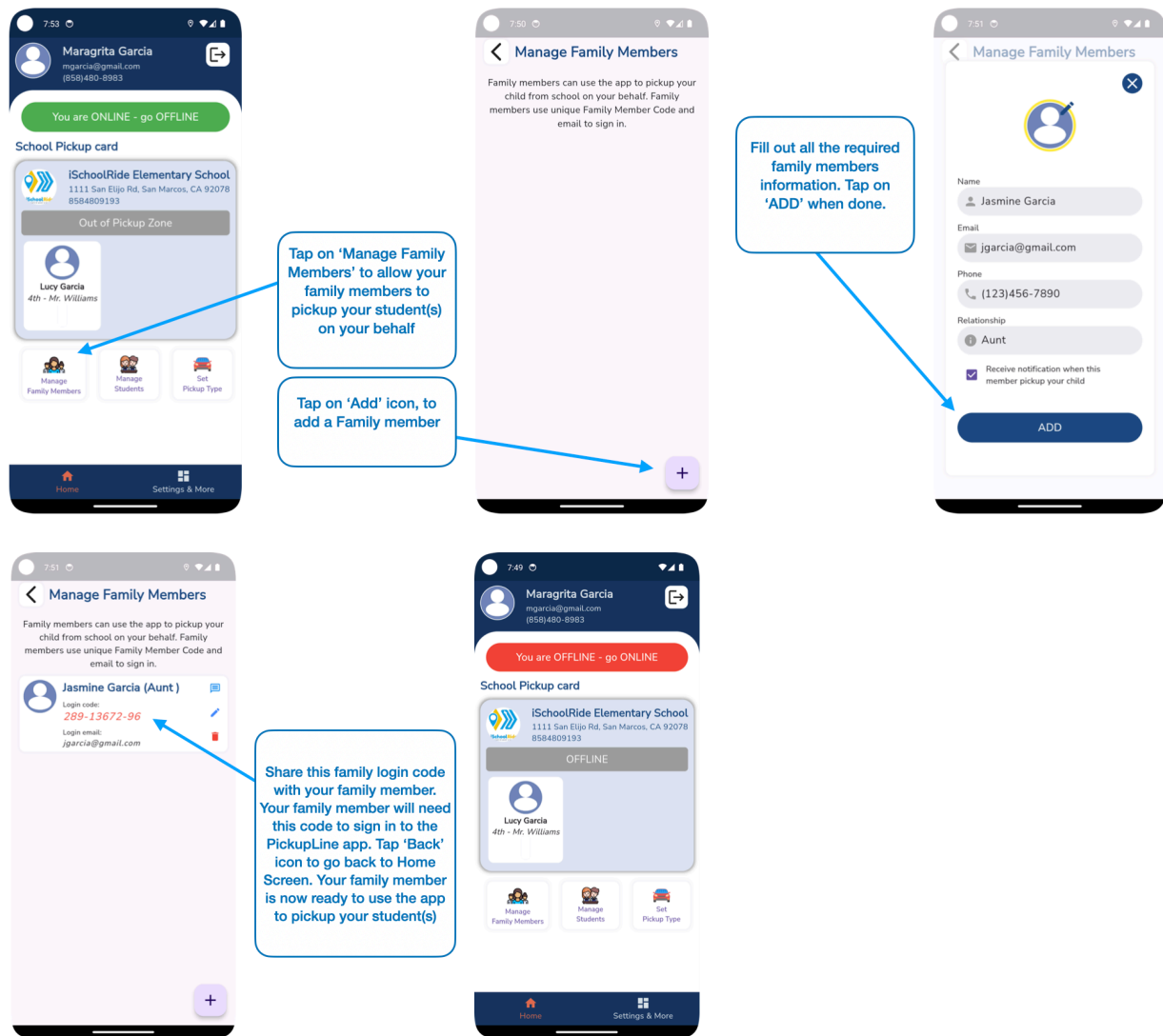

Step 1:

From the Home Screen, tap **'Manage Family Members'** to access the Family Members screen.

Step 2:

Tap the **'Add'** icon and enter all required information for the family member you wish to add.

Step 3:

Once you've entered the family member's details, tap **'ADD'**. A **'Family Code'** will be generated. This code is needed by your family member to sign in to the iSchoolRide PickupLine app and pick up your student(s).

Step 4:

Share the **'Family Code'** with the designated family member. Ensure that the code is shared only with the intended person. Your family member is now ready to use the iSchoolRide PickupLine app to pickup your student(s) on your behalf.

4. Family Member Pickup

Family members will need the Family Code you created in the iSchoolRide PickupLine app to sign in. A graphical guide is also included for your convenience.

Step 1:

Tap **'LOGIN as Family Member'** on the iSchoolRide PickupLine app to begin the sign-in process.

Step 2:

Enter the Family Code provided to you to sign in.

Step 3:

When you're ready to pick up your student(s), tap **'Go Online'** to notify teachers/admins that you have arrived in the Pickup Zone. Make sure to:

- Select **'Allow'** on the location access prompt.

- Choose **'Precise'** location access.
- Select **'While using the app'** for location access.

Step 4:

You're all set! You can now use the iSchoolRide PickupLine app to pick up your student(s).

For Family Members, tap on 'LOGIN as Family Member' to sign in to the iSchoolRide PickupLine app

Enter valid Family Code to sign in

Tap on 'go ONLINE' button to start using the app to pickup you student(s)

Make sure to allow location access so that teachers/admins know that you are in the Pickup zone and dismiss your student(s)

Make sure to choose 'Precise' and 'While using the app'. iSchoolRide only collects your location and share with teachers/admins while you are in Pickup zone in order to release your students

ISCHOOLRIDE

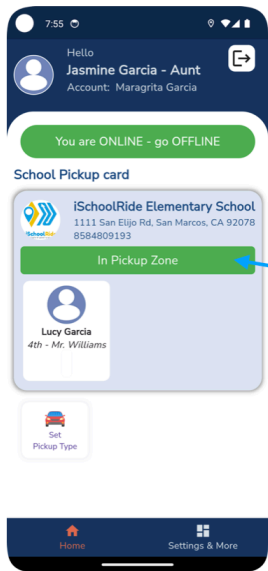

You are all set to pickup your student(s). When you are in Pickup zone, this button will turn green. Admin will be able to release your student(s)